



MADERRA

Hidden Bookshelf Doors

INSTALLATION INSTRUCTIONS.

Please read this entire manual before you begin.

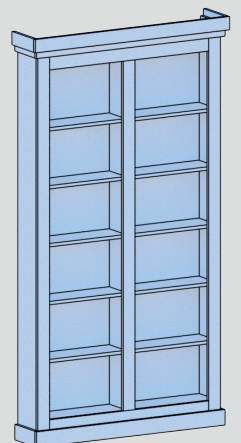

INSTALLATION INSTRUCTIONS.

Please read this entire manual before you begin.

⚠️ WARNING!

This product contains small parts that can be a choking hazard. Do not let children play with any of these small parts! Keep children away from the work area during installation.

⚠️ CAUTION!

This product is intended to be installed by professional installation contractors or persons familiar with the tools and methods required for this installation. If you are not sure about your ability to perform this installation, you must contact a professional. Maderra is not responsible for damage or injury caused by incorrect installation or improper use.

⚠️ CAUTION!

Do not use this product in any way, or for any purpose, that is not specifically described in these instructions. Maderra is not responsible for damage or injury caused by incorrect installation or improper use.

⚠️ WARNING!

Do not install or place Bookshelf Door or wood parts close to fire or heat.

⚠️ CAUTION!

Two people required for some parts of the installation process.

SUMMARY - INSTALLATION INSTRUCTIONS BROCHURE

A. Pallet Content for Sliding Doors.....	3
B. Existing Door Entrance.....	3
C. Assembly Wheels, Roller Guide, and Top Crown Molding...	4
D. Install Sliding Rail	5
E. Instaling Bottom Rail.....	6

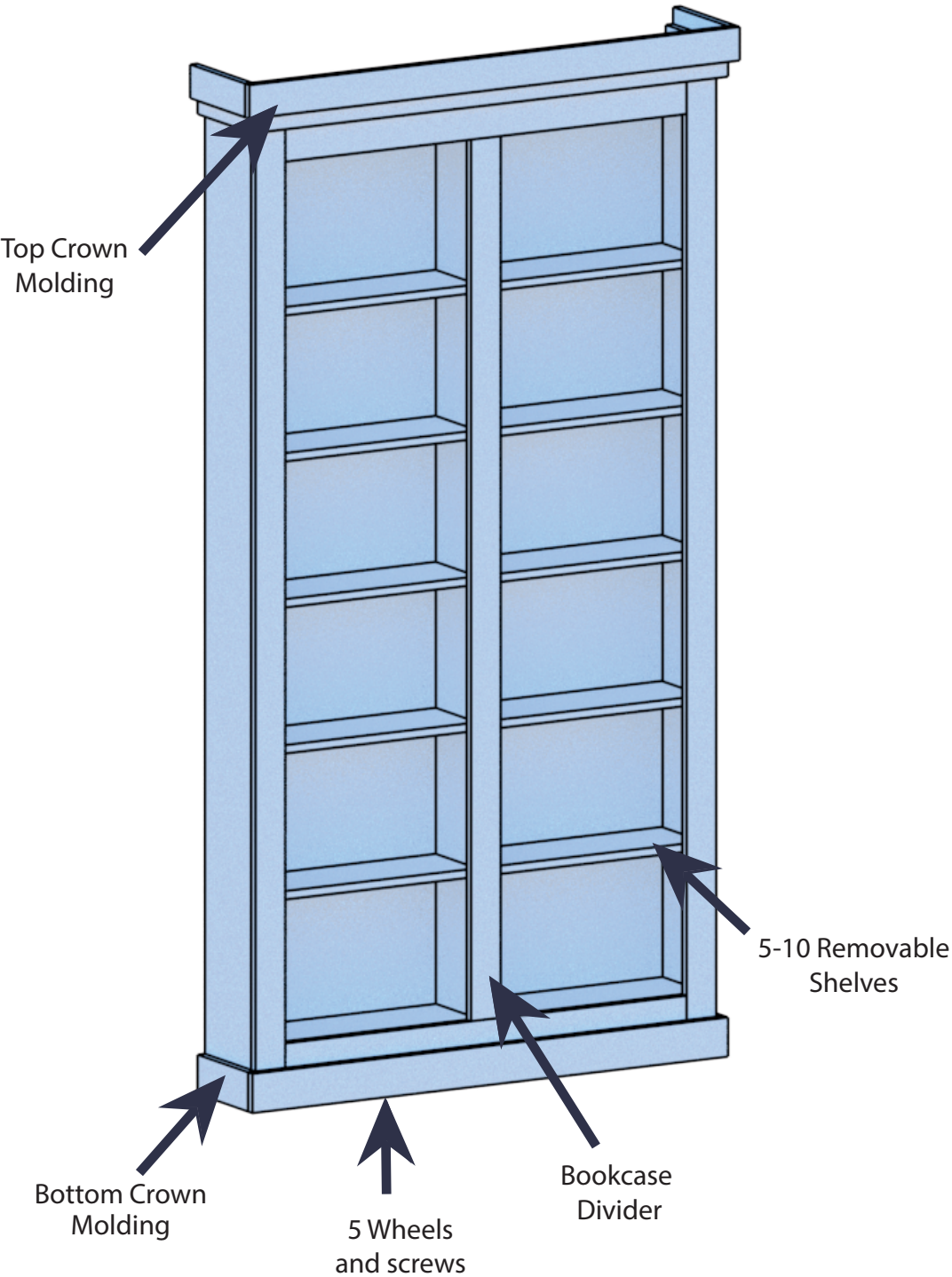

A. Pallet Content for Sliding Doors.

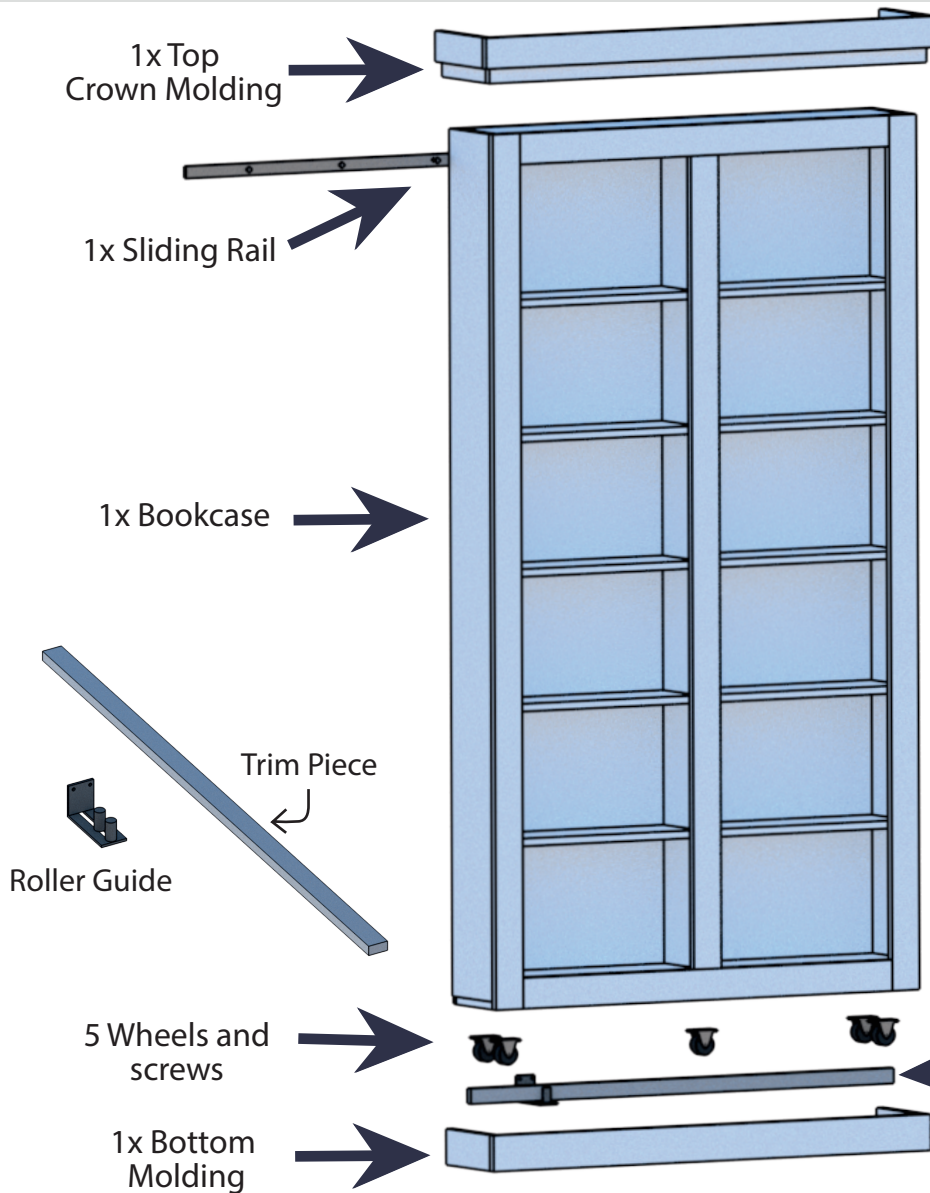

What you need:



a. Drill



b. Square Drill Bit



c. Stud Finder



d. Nail Gun



e. Level

! CAUTION!

Two people are recommended for the installation process. The assembly might involve heavy lifting!

The Trim Piece prevents your Sliding Door from swaying away from the wall.

B. Existing Door Entrance.



1. If your existing door opens in the opposite direction of your Sliding Door, you do not need to remove your existing door. (Optional)

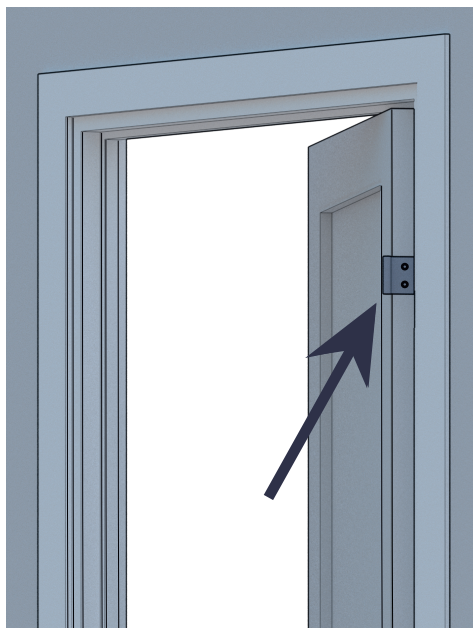

2. If you have decided to remove your old door, remove the Hinges and the Door.

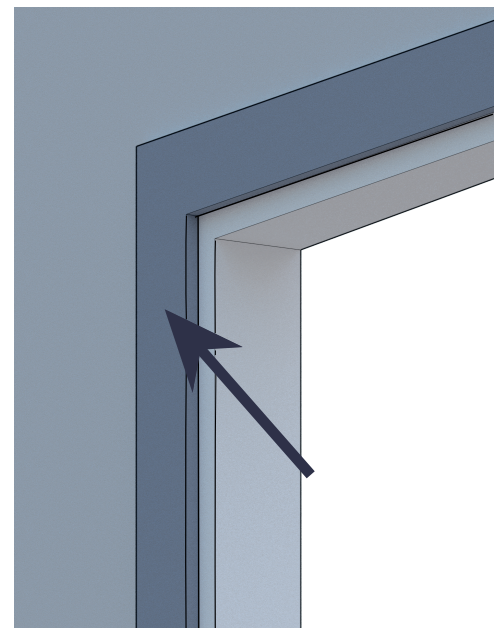

3. Do not remove the Door Casing.

C. Assembly Wheels, Roller Guide, and Top Crown Molding

1. Wheels

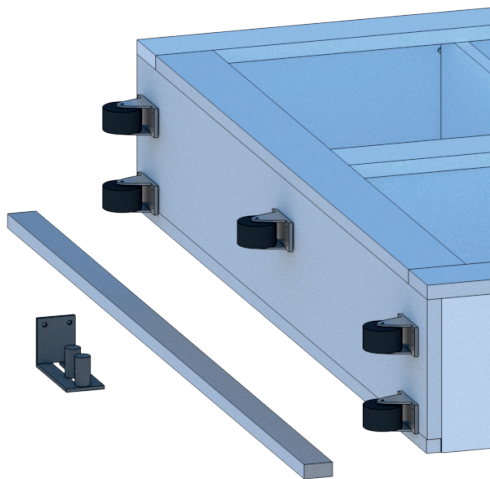

1.1. Lay down the Sliding Bookshelf Door facing up. Place it on a carpet or a thick blanket to avoid marks and scratches.

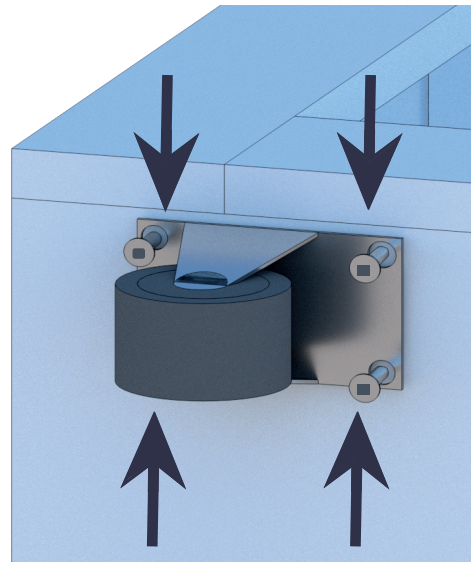

1.2. Screw in place the wheels using the pre-made holes. Repeat the process for all Wheels

2. Roller Guide

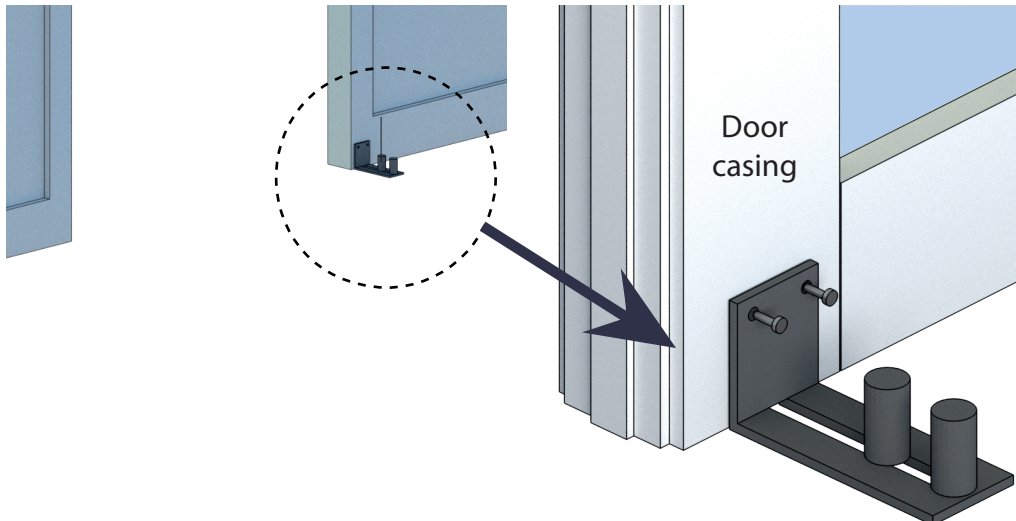

2.1. Let aside the Bookcase for now. Take the Roller Guide and install it into the existing Door Casing

2.2. Do not let the Roller Guide hang in the air. Let it touch the floor and screw it in the Door Casing.

3. Top Crown Molding

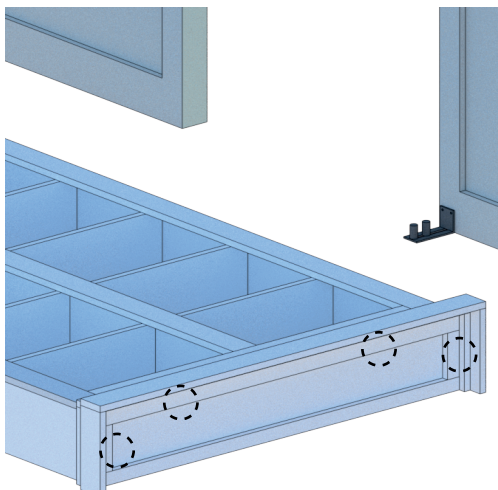

3.1 Attach the Top Crown Molding to the Bookcase and screw it in place.

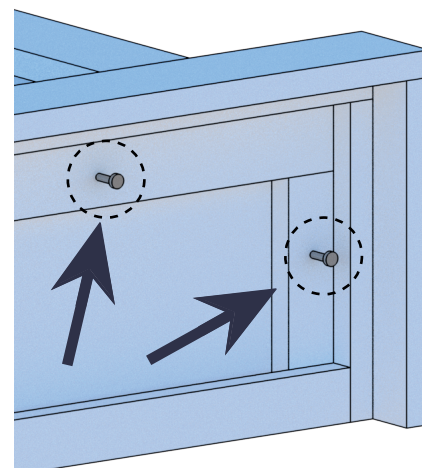

3.2 Use the screws provided in the package to attach the Top Crown Molding to your Bookcase.



D. Install Sliding Rail.

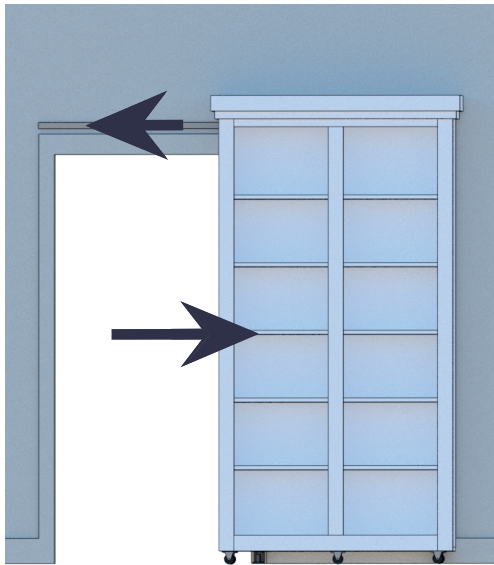

1. Lift and position the Sliding Bookshelf in the right way that needs to be opened. Pull the Sliding Rail and mark with a pencil where it will be screwed into the wall.

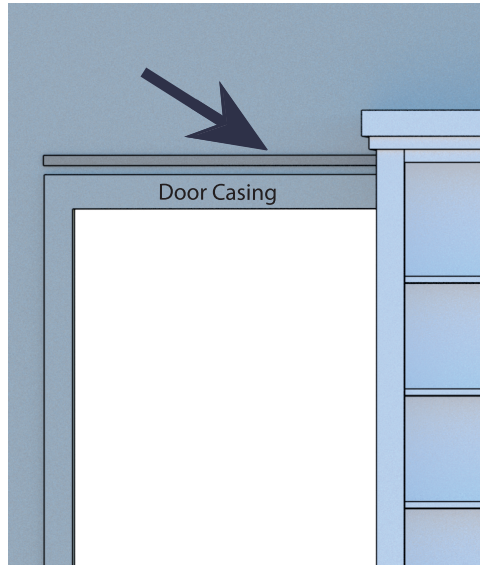

2. To install the Sliding Rail, find the center of the door entrance, right above the Door Casing. Find the center so that when you Slide the door into the closed position, the door covers the door casing equally.

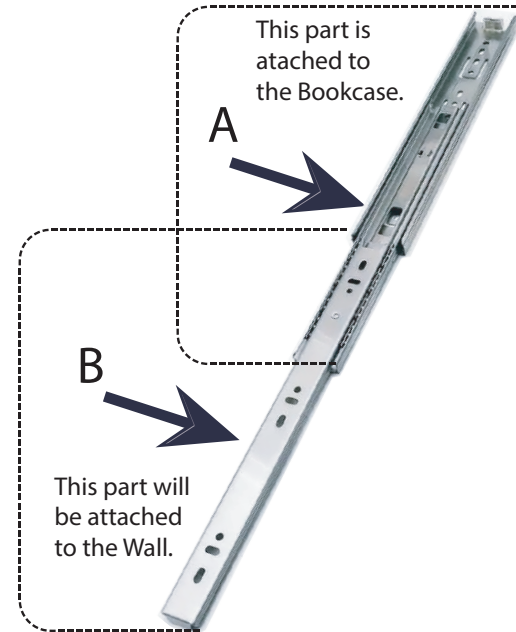

3. Separate the Sliding Rail by finding the Plastic Pin and pressing it to detach it from the main body.

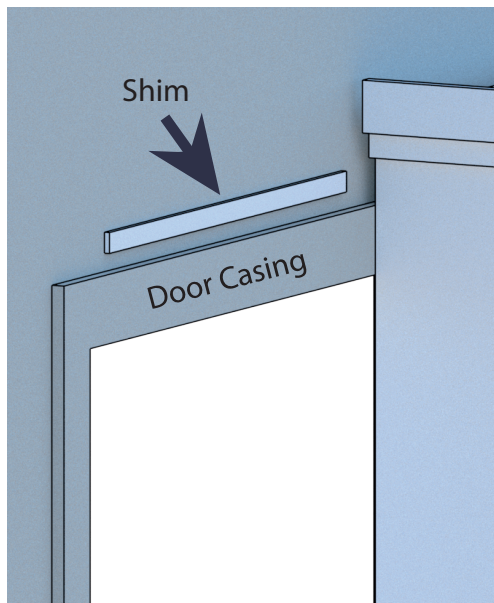

1. If you have a Door Casing on your door entrance, we recommend shimming the Sliding Rail to bring it forward, so the Sliding Door will not hit the Door Casing. Use the marks that you previously did to place your shim.

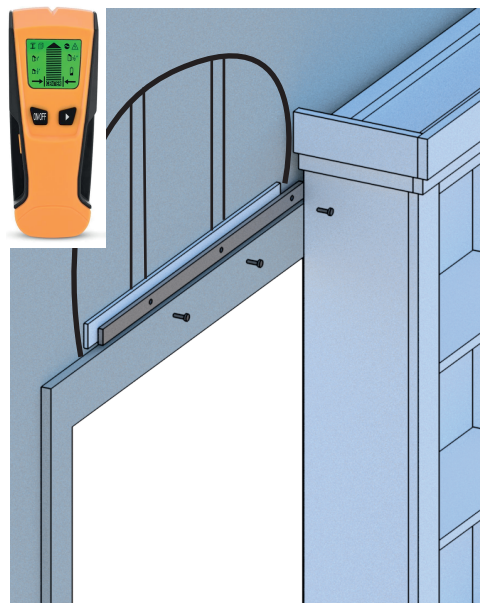

2. Use a Stud Finder to find the studs in the wall.



3. Screw the shim and Sliding Rail in place at the same time. Uneven Sliding Rail will create a rubbing effect when you want to slide the Door. Don't forget to level it.

! CAUTION!

Keep children away from the work area during installation. Do not let children play with the small parts of your Sliding Door.

E Installing Bottom Rail and Molding

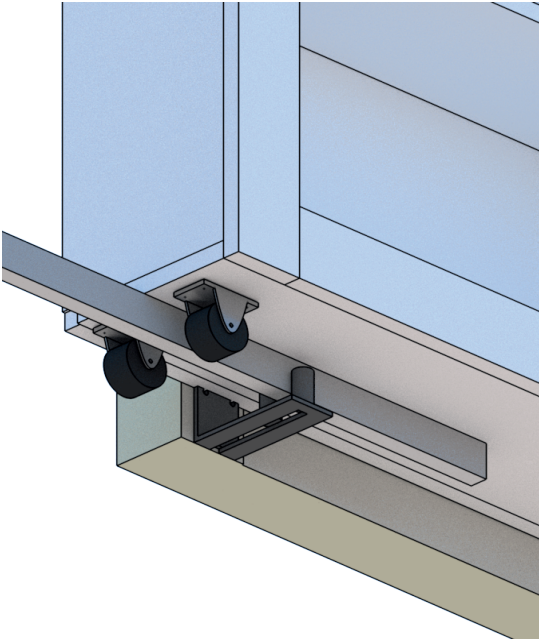

1. Mark with a pencil where the Trim piece needs to be installed.

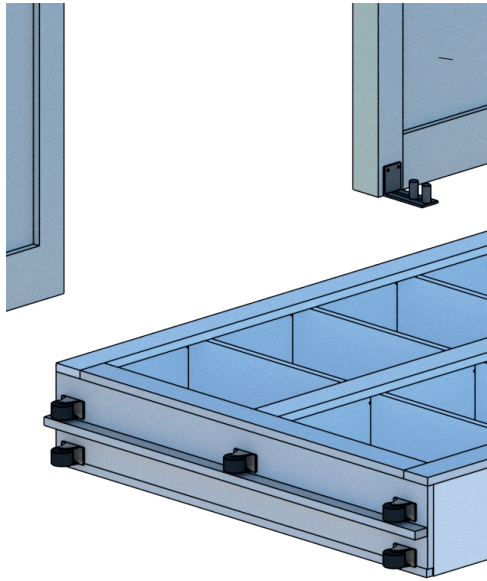

2. Lay down the Bookcase and screw in the Trim piece using the Pocket Holes.



Drill



Square Drill Bit

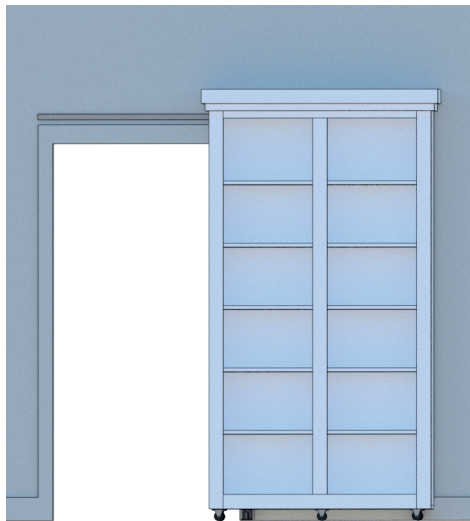

3. Place the Sliding Door back on the wall. Make sure that it closes and opens smoothly. Make any adjustments if needed.



4. Nail in the Bottom Molding to your Bookcase using a Nail Gun. Leave a slight gap between your floor, so the Bottom Molding does not drag against the floor.



Nail Gun



1. If your Bookshelf Door has Bottom Cabinets and you ordered cabinet hardware, now is the time to install them.